

1
2 THRU 19

2
3 THRU 18

5
6 THRU 11

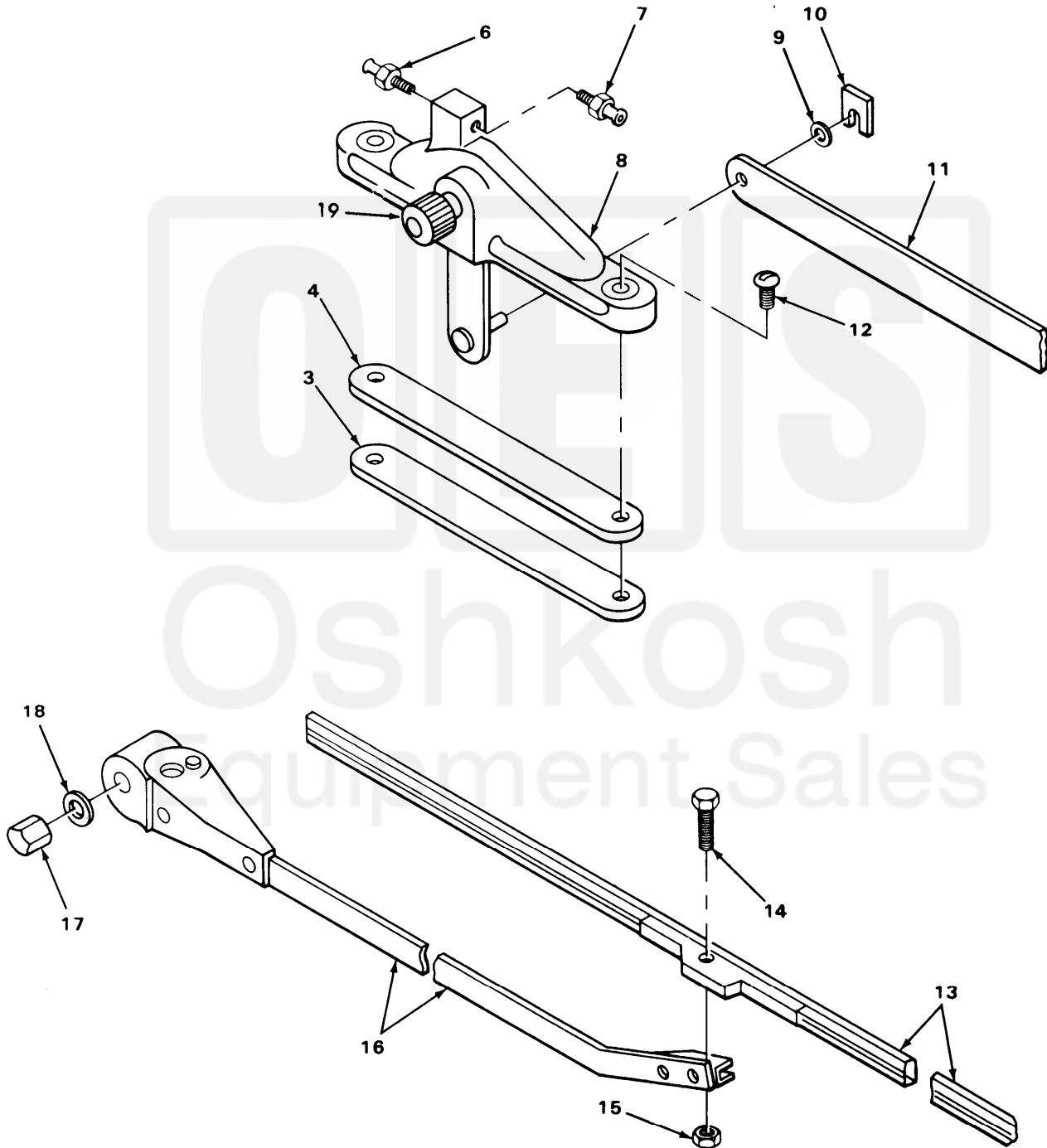

TA217210

FIGURE 279. WINDSHIELD WIPER ASSEMBLY.

Current part is item (16) on diagram. Available at www.oshkoshequipment.com

| SECTION II (1) | ITEM (2) | SMR (3) | FSCM (4) | TM9-2320-273-24P PART NUMBER | (5) | DESCRIPTION AND USABLE ON CODE (UOC) | (6) |
|-------------------|-------------|------------|--------------|------------------------------------|-----|--|-----|
| | | | | | | GROUP:22 CHASSIS AND HULL ACCESSORY ITEMS GROUP:2202 ACCESSORY ITEMS | |
| | | | | | | FIGURE 279. WINDSHIELD WIPER ASSEMBLY. | |
| 1 | PAOOO | 34623 | 5932051 | | | ASSY,WASHER AND WIP | 1 |
| 2 | PAOOO | 60703 | 9102-13 | | | .WINDSHIELD WIPER | 2 |
| 3 | PBOZZ | 60703 | A86448J | | | ..SPACER,PLATE | 2 |
| 4 | PBOZZ | 60703 | 86447 | | | ..GASKET | 2 |
| 5 | PBOOO | 34623 | 5731520 | | | ..PIVOT BODY ASSEMBLY AND CONNECTING ARM LH | 1 |
| 5 | PBOOO | 60703 | 89142-121ZF | | | ..PIVOT ASSEMBLY,WIND AND CONNECTING ARM RH | 1 |
| 6 | PAOZZ | 60703 | 88171-4JD | | | ...NOZZLE,WINDSHIELD UOC:U22,U23,U24,U25,U26 | 2 |
| 7 | PAOZZ | 60703 | 86022-4JD | | | ...ADAPTER,STRAIGHT,TU | 2 |
| 8 | PAOZZ | 60703 | 86446-2BC | | | ...PIVOT,BODY | 2 |
| 9 | PBOZZ | 60703 | 95000-37J | | | ...WASHER,FLAT | 2 |
| 10 | PAOZZ | 60703 | 78647-1J | | | ...CLIP,SPRING TENSION | 2 |
| 11 | PFOZZ | 60703 | 89340-284 | | | ...ARM,WINDSHIELD WIPE | 1 |
| 11 | PFOZZ | 60703 | 89339-345 | | | ...CONNECTING LINK,RIG | 1 |
| 12 | PAOZZ | 60703 | 86941-18JD | | | ..SCREW,MACHINE | 4 |
| 13 | PAOZZ | 34623 | 88600-47E | | | ..BLADE,WINDSHIELD WI | 1 |
| 14 | PAOZZ | 60703 | NO.5-40X9/16 | | | ..SCREW,MACHINE | 2 |
| 15 | PAOZZ | 60703 | NO.5-40 | | | ..NUT,PLAIN,HEXAGON | 2 |
| 16 | PAOZZ | 60703 | 90981-15BC | | | ..ARM,WINDSHIELD WIPE LH | 1 |
| 16 | PAOZZ | 60703 | 90982-15EC | | | ..ARM,WINDSHIELD WIPE RH UOC:U22,U23,U24,U25,U26 | 1 |
| 17 | PAOZZ | 60703 | 75026-2ZF | | | ..NUT,PLAIN,CAP | 2 |
| 18 | PAOZZ | 60703 | 2397-J | | | ..WASHER,LOCK | 2 |
| 19 | PAOZZ | 60703 | 86324-13 | | | ..BUSHING,TAPERED | 1 |

END OF FIGURE



Current part is item (16) on diagram. Available at www.oshkoshequipment.com